



Lenox Cabinet Small

UA2570 BA

- \$1,750 Polished Brass
- \$1,900 Green Patina*, Brown Patina*
- \$2,100 Antique Brass*
 - Statuary Brown [gloss or matte]*
 - Statuary Black [gloss or matte]*
- \$2,300 Polished Nickel, Satin Nickel*, Light Pewter*
 - Polished Chrome, Black Nickel [gloss or matte]*
 - Burnished Nickel

***** Custom finishes not returnable

Notes: Our metals are living finishes; they will change over time and will never rust

Mirrors with square corners come flat or beveled, please specify.

Set includes frame and door only

Custom brackets incur a \$600 fee per cabinet because they require custom fitting and machining at our factory

Marble box sold separately

Marble box comes with a fixed marble shelf
See page 2 for stone options



Installation instructions available online for download

- \$250 Replacement Mirror with no Bevel
 - 6 5/8" × 12 7/8"
 - UA6132-S BG

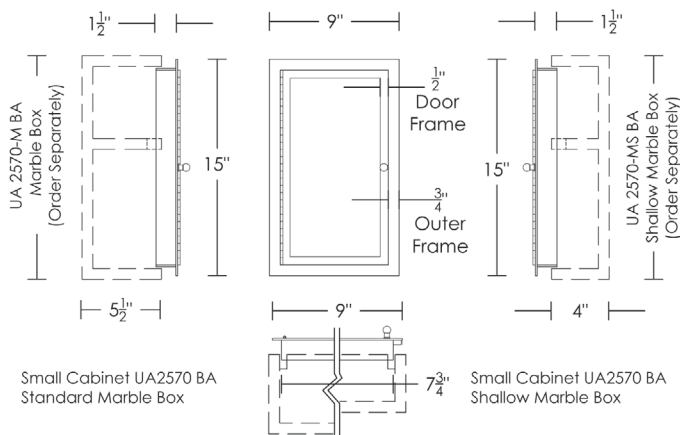

Small Standard Depth Marble Box
UA2570-M BA

Interior Dimensions:
8"w x 14"h x 4 3/4"d

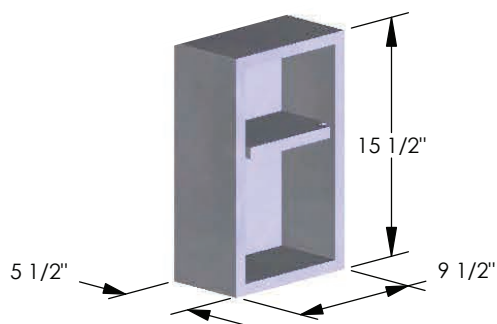

Lenox Marble Box Small

Standard UA2570-M BA
Shallow UA2570-MS BA

Standard & Shallow

Call for Linea Stone, Lagos Azul
pricing

Carrara, Statuary Michelangelo,
Rosa Verona, Blue Celeste

Black Mosaic Granite, Blue Persa Granite,
Verde Fuoco Granite

White Onyx, Statuary White, Calacatta Gold,
Thassos, Absolute Black Granite

Notes: Small Marble boxes are made
with one fixed marble shelf

Lenox Cabinet Small door and frame
fits on both small marble boxes

Small Shallow Depth Marble Box
UA2570-MS BA

Interior Dimensions:
8"w x 14"h x 3 1/4"d

