



Industrial Base [1 1/2"Ø]

Industrial Base 2 Legs [1 1/2"Ø]

Metal UA2751 SL

Glass UA2751-G SL

Metal	Glass	
\$4,800	\$4,400	Polished Brass
\$6,300	\$4,800	Green Patina, Brown Patina
\$6,500	\$5,000	Antique Brass Statuary Brown [gloss or matte] Statuary Black [gloss or matte]
\$6,800	\$5,800	Polished Nickel, Satin Nickel Light Pewter, Polished Chrome Black Nickel [gloss or matte]

***** Washstands and tops are not returnable

Options: Click on washstand's Options Tab on website for:
Cap & Foot
Metal Finishes
Stone Sizes and Edge Profiles
Stone
Basins
Extended P-Trap

Notes: Our metals are living finishes; they will change over time and will never rust

Stone tops are sold separately [UA3026 WT 2" thick Routed Top shown]

Extended P-Trap is required
UA0002 PL

\$385	Price 1
\$420	Price 2
\$490	Price 3
\$595	Price 4

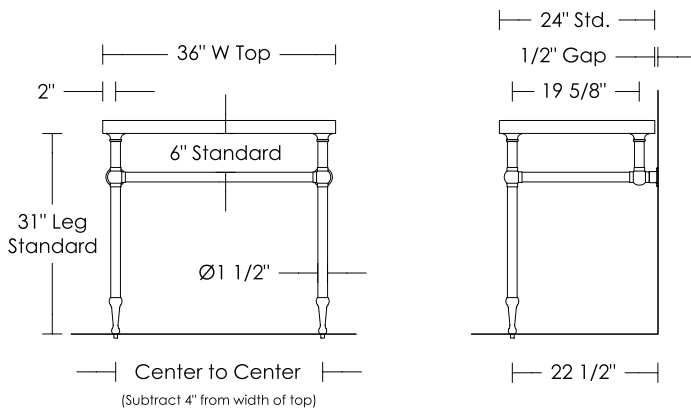

UA2751 SL 2 Legs [1 1/2"Ø]
with Mott Cap & Foot

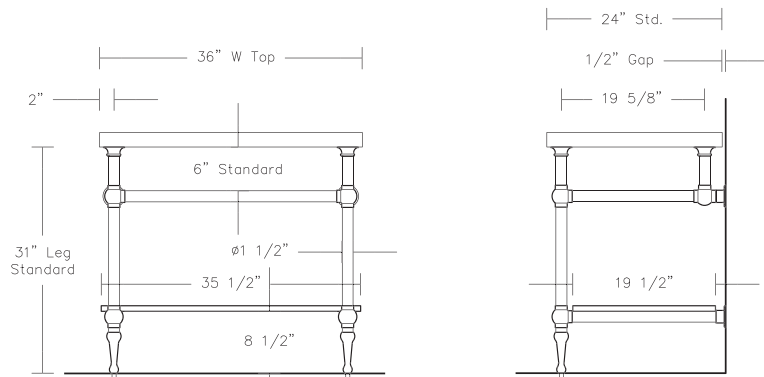

UA2751-B SL 2 Legs [1 1/2"Ø] with 2 Lower Bars
with Mott Cap & Foot

Industrial Base [1 1/2"Ø]

Industrial Base 2 Legs [1 1/2"Ø] with 2 Lower Bars

Metal UA2751-B SL
Glass UA2751-G-B SL

Metal	Glass	
\$6,800	\$5,800	Price 1
\$8,300	\$6,200	Price 2
\$8,500	\$6,400	Price 3
\$8,800	\$6,600	Price 4

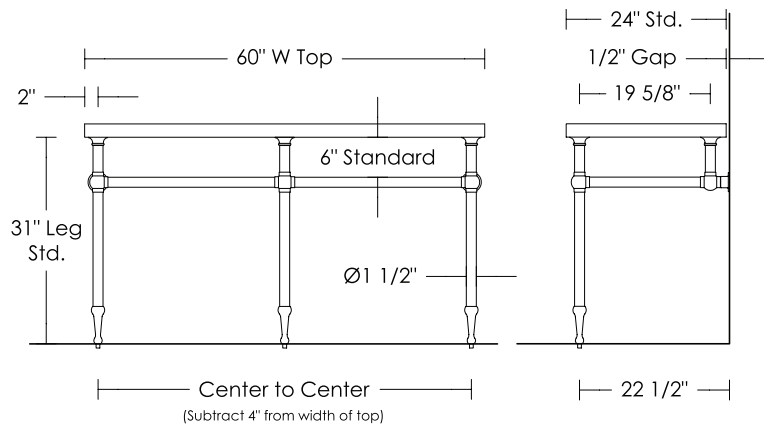

UA2752 SL 3 Legs [1 1/2"Ø]
with Mott Cap & Foot

Industrial Base 3 Legs [1 1/2"Ø]

Metal UA2752 SL
Glass UA2752-G SL

Metal	Glass	
\$6,000	\$6,400	Price 1
\$7,500	\$6,700	Price 2
\$7,600	\$6,900	Price 3
\$7,800	\$7,200	Price 4

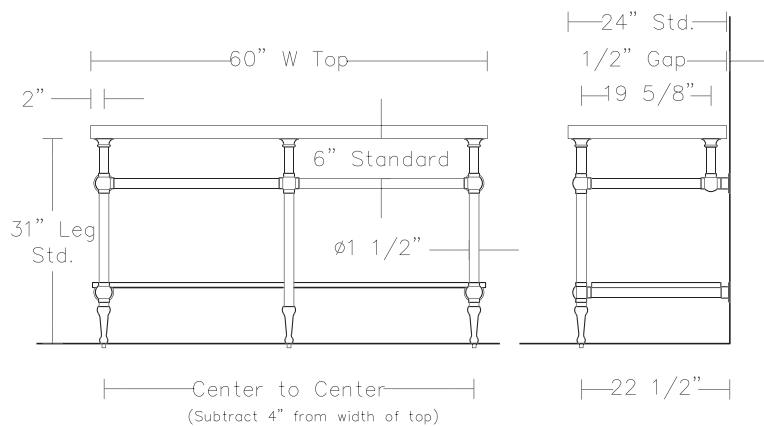

UA2752-B SL 3 Legs [1 1/2"Ø] with 2 Lower Bars
with Mott Cap & Foot

Industrial Base 3 Legs [1 1/2"Ø] with 2 Lower Bars

Metal UA2752-B SL
Glass UA2752-G-B SL

Metal	Glass	
\$8,000	\$7,400	Price 1
\$10,000	\$7,700	Price 2
\$10,500	\$7,900	Price 3
\$11,200	\$9,400	Price 4

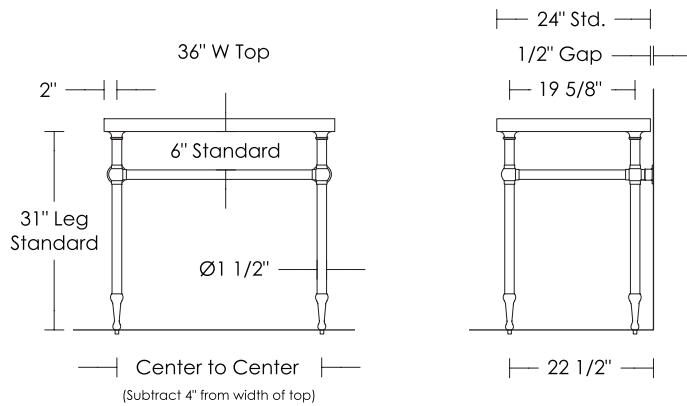

UA2753 SL 4 Legs [1 1/2"Ø]
with Mott Cap & Foot

Industrial Base [1 1/2"Ø]

Industrial Base 4 Legs [1 1/2"Ø]

Metal UA2753 SL
Glass UA2753-G SL

Metal	Glass	
\$7,800	\$7,200	Price 1
\$9,300	\$7,600	Price 2
\$9,500	\$7,800	Price 3
\$10,300	\$8,200	Price 4

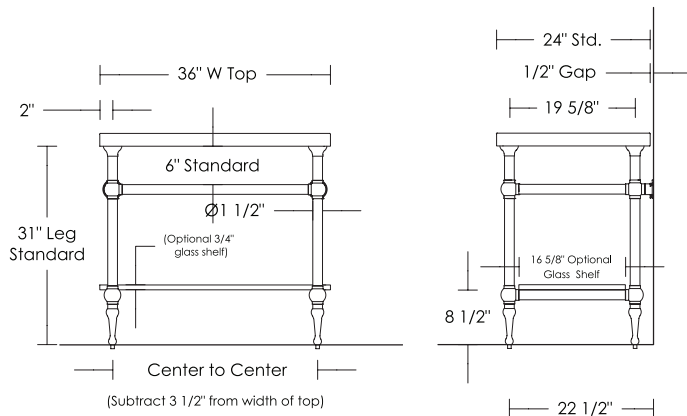

UA2753-B SL 4 Legs [1 1/2"Ø] with 2 Lower Bars
with Mott Cap & Foot

Industrial Base 4 Legs [1 1/2"Ø] with 2 Lower Bars

Metal UA2753-B SL
Glass UA2753-G-B SL

Metal	Glass	
\$9,800	\$9,200	Price 1
\$11,800	\$9,600	Price 2
\$12,200	\$9,800	Price 3
\$12,800	\$10,500	Price 4



Industrial Base 4 Legs [1 1/2"Ø] with 4 Lower Bars
 UA2753-G-4B SL

- \$11,500 Price 1
- \$13,900 Price 2
- \$14,200 Price 3
- \$15,100 Price 4

Includes 4 glass bars, 4 returns,
 4 glass bars for lower shelf, and center connector

Call for pricing for bases over 72"

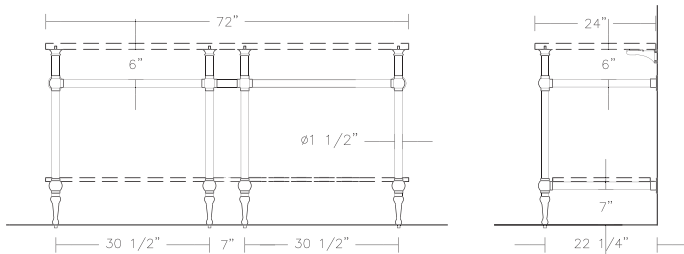

UA2753-4B SL 4 Legs [1 1/2"Ø] with 4 Lower Bars
 with Mott Cap & Foot

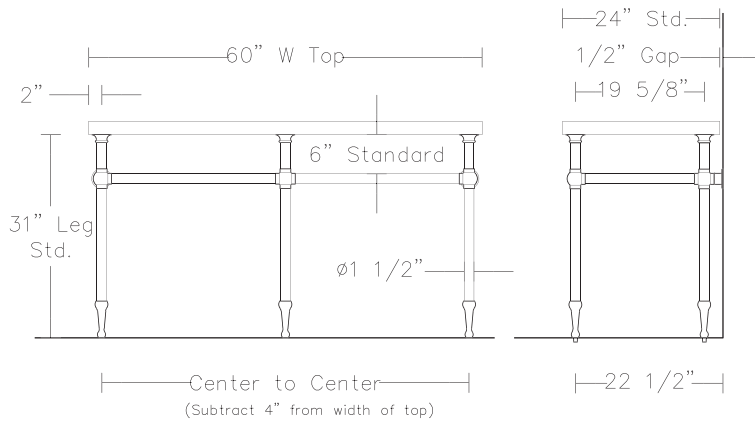

UA2754 SL 5 Legs [1 1/2"Ø]
with Mott Cap & Foot

Industrial Base [1 1/2"Ø]

Industrial Base 5 Legs [1 1/2"Ø]

Metal UA2754 SL
Glass UA2754-G SL

Metal	Glass	
\$8,800	\$8,000	Price 1
\$9,800	\$8,600	Price 2
\$10,200	\$8,800	Price 3
\$10,800	\$9,000	Price 4

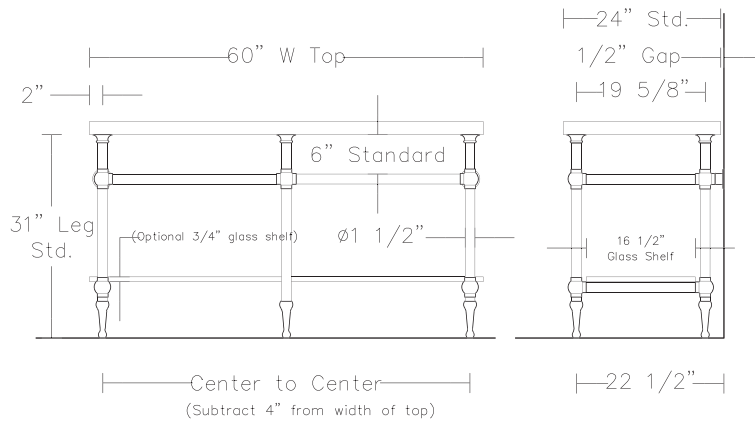

UA2754-B SL 5 Legs [1 1/2"Ø] with 2 Lower Bars
with Mott Cap & Foot

Industrial Base 5 Legs [1 1/2"Ø] with 2 Lower Bars

Metal UA2754-B SL
Glass UA2754-G-B SL

Metal	Glass	
\$10,800	\$10,000	Price 1
\$11,800	\$10,800	Price 2
\$12,000	\$11,200	Price 3
\$13,200	\$12,000	Price 4

Call for pricing
Optional glass shelf
for 18" x 60" x 3/4"
pricing UA3073-60-WT

Shelves over 48" need additional support

Call for pricing for stone shelf

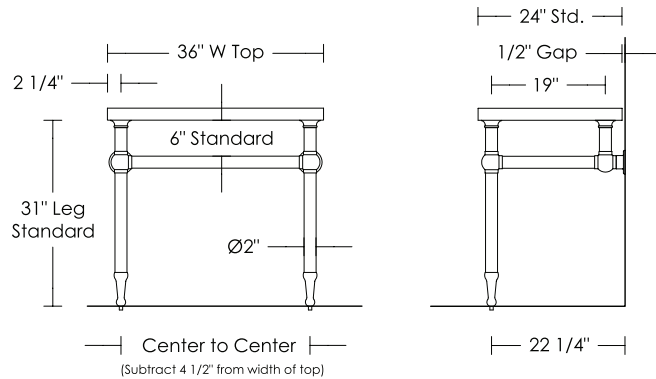

UA2761 SL 2 Legs [2"Ø]
with Mott Cap & Foot

Industrial Base [2"Ø Metal]

Industrial Base 2 Legs [2"Ø]

UA2761 SL

- \$5,800 Polished Brass
- \$7,300 Green Patina, Brown Patina
- \$7,500 Antique Brass
Statuary Brown [gloss or matte]
Statuary Black [gloss or matte]
- \$7,800 Polished Nickel, Satin Nickel, Light Pewter
Polished Chrome
Black Nickel [gloss or matte]

* Washstands and tops are not returnable

- Options: Click on washstand's Options Tab on website for:
- Cap & Foot
 - Metal Finishes
 - Stone Sizes and Edge Profiles
 - Stone
 - Basins
 - Extended P-Trap

Notes: Our metals are living finishes; they will change over time and will never rust

Stone tops are sold separately

Extended P-Trap is required
UA0002 PL

- \$385 Price 1
- \$420 Price 2
- \$490 Price 3
- \$595 Price 4

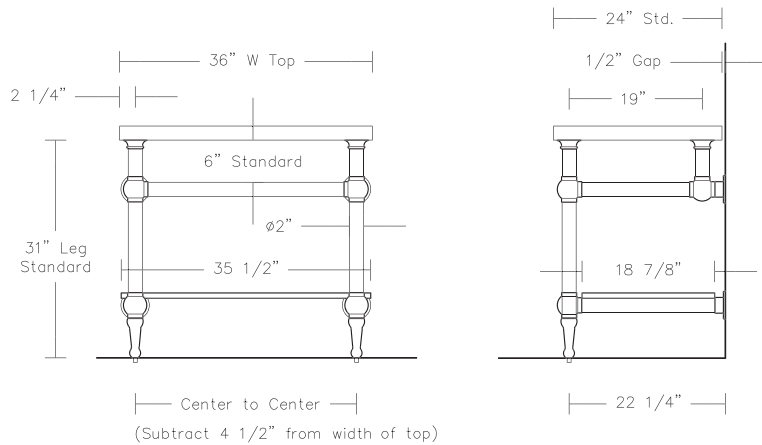

UA2762-B SL 2 Legs [2"Ø] with 2 Lower Bars
with Mott Cap & Foot

Industrial Base [2"Ø Metal]

Industrial Base 2 Legs [2"Ø] with 2 Lower Bars

UA2761-B SL

- \$7,800 Price 1
- \$9,300 Price 2
- \$9,500 Price 3
- \$9,800 Price 4

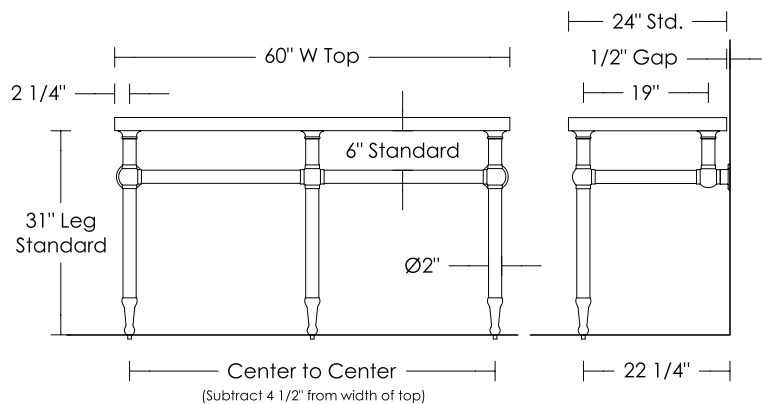

UA2762 SL 3 Legs [2"Ø]
with Mott Cap & Foot

Industrial Base 3 Legs [2"Ø]

UA2762 SL

- \$7,000 Price 1
- \$8,500 Price 2
- \$8,600 Price 3
- \$8,800 Price 4

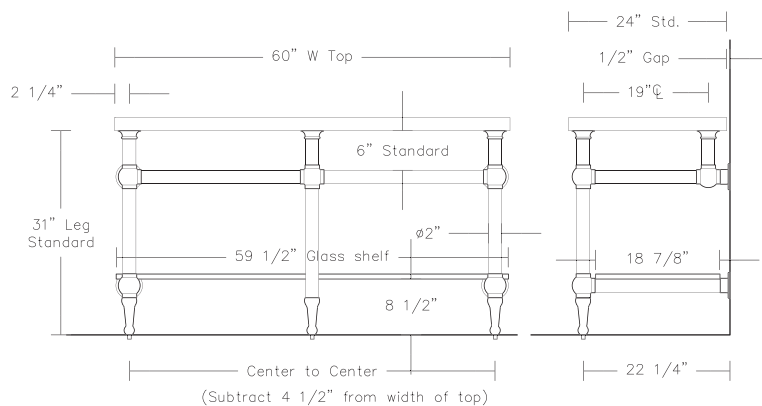

UA2762-B SL 3 Legs [2"Ø] with 2 Lower Bars
with Mott Cap & Foot

Industrial Base 3 Legs [2"Ø] with 2 Lower Bars

UA2762-B SL

- \$9,000 Price 1
- \$10,500 Price 2
- \$10,700 Price 3
- \$12,500 Price 4

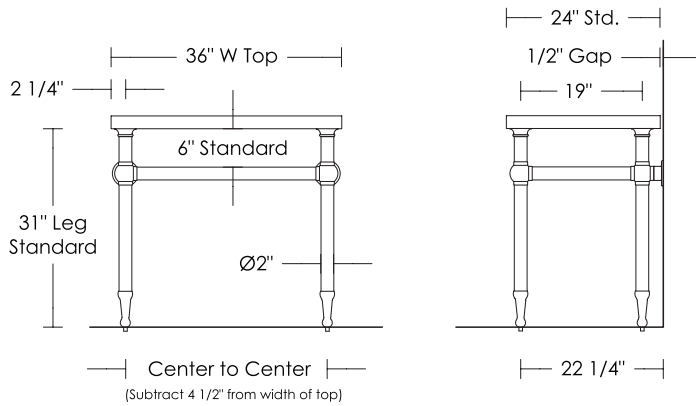

UA2763 SL 4 Legs [2"Ø]
with Mott Cap & Foot

Industrial Base [2"Ø Metal]

Industrial Base 4 Legs [2"Ø]

UA2763 SL

- \$8,800 Price 1
- \$9,800 Price 2
- \$10,100 Price 3
- \$11,800 Price 4

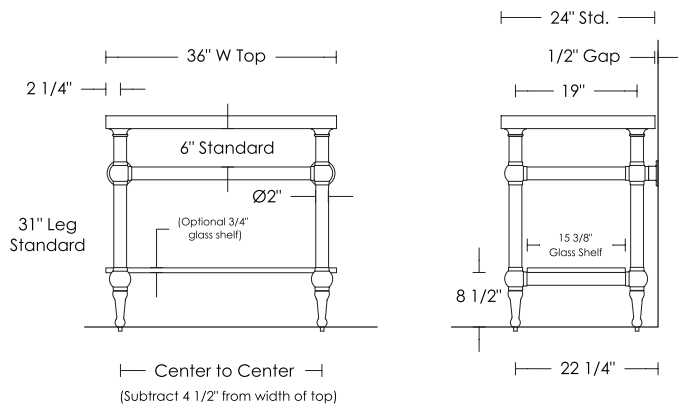

UA2763-B SL 4 Legs [2"Ø] with 2 Lower Bars
with Mott Cap & Foot

Industrial Base 4 Legs [2"Ø] with 2 Lower Bars

UA2763-B SL

- \$10,300 Price 1
- \$11,500 Price 2
- \$11,700 Price 3
- \$13,800 Price 4

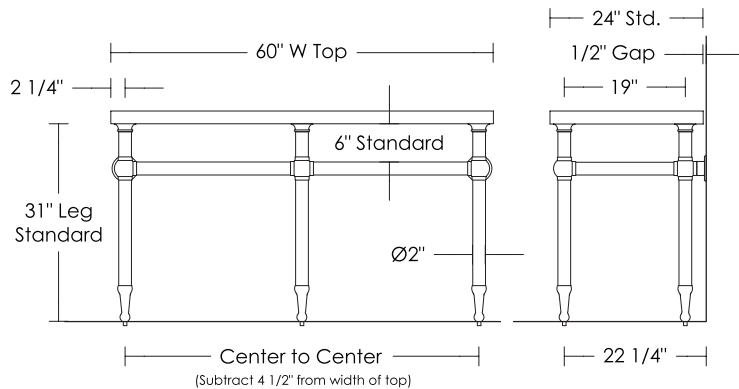

UA2764 SL 5 Legs [2"Ø]
with Mott Cap & Foot

Industrial Base [2"Ø Metal]

Industrial Base 5 Legs [2"Ø]

UA2764 SL

- \$9,900 Price 1
- \$10,900 Price 2
- \$11,100 Price 3
- \$11,900 Price 4

Industrial Base 5 Legs [2"Ø] with 2 Lower Bars

UA2764-B SL

- \$11,800 Price 1
- \$12,800 Price 2
- \$13,000 Price 3
- \$14,800 Price 4

Optional glass shelf

- \$425 18" x 30" x 3/4" UA3073-30-WT
- \$490 18" x 36" x 3/4" UA3073-36-WT
- \$535 18" x 42" x 3/4" UA3073-42-WT
- \$595 18" x 48" x 3/4" UA3073-48-WT
- \$725 18" x 60" x 3/4" UA3073-60-WT

Shelves over 48" need additional support

Call for pricing for stone shelf

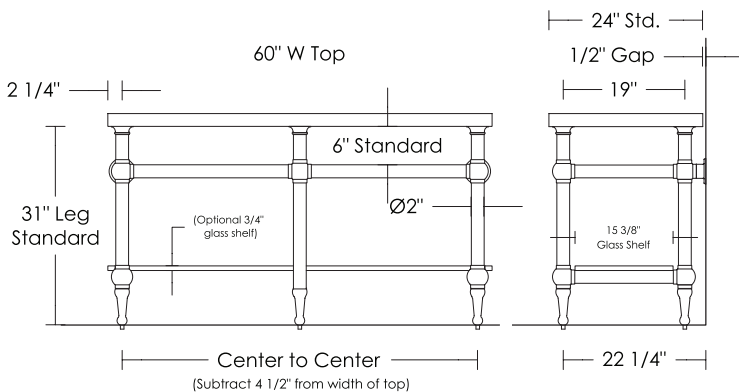

UA2764-B SL 5 Legs [2"Ø] with 2 Lower Bars
with Mott Cap & Foot

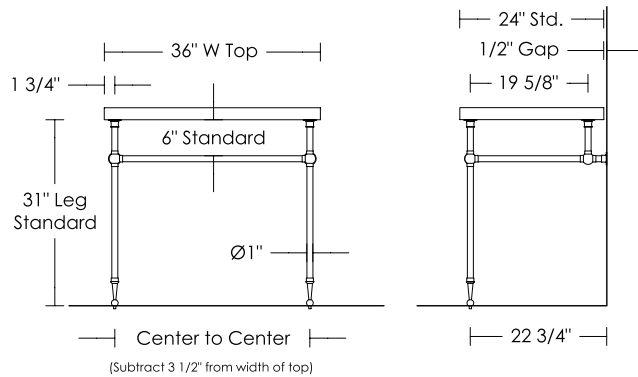

UA2741 SL 2 Legs [1"Ø]
with Mott Cap & Foot

Industrial Base [1"Ø Metal]

Industrial Base 2 Legs [1"Ø]

UA2741 SL

\$3,600 Polished Brass

\$5,100 Green Patina, Brown Patina

\$5,300 Antique Brass
Statuary Brown [gloss or matte]
Statuary Black [gloss or matte]

\$5,600 Polished Nickel, Satin Nickel, Light Pewter
Polished Chrome
Black Nickel [gloss or matte]

***** Washstands and tops are not returnable

- Options: Click on washstand's
Options Tab on website for:
Cap & Foot
Metal Finishes
Stone Sizes and Edge Profiles
Stone
Basins
Extended P-Trap

Notes: Our metals are living finishes;
they will change over time and
will never rust

Stone tops are sold separately

Extended P-Trap is required
UA0002 PL

- \$385 Price 1
- \$420 Price 2
- \$490 Price 3
- \$595 Price 4

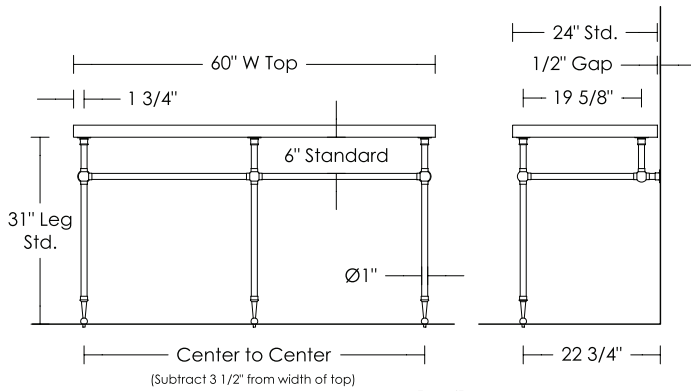

UA2742 SL 3 Legs [1"Ø]
with Mott Cap & Foot

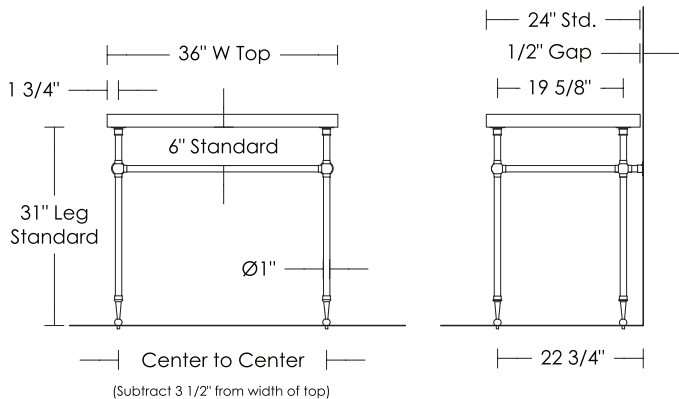

UA2743 SL 4 Legs [1"Ø]
with Mott Cap & Foot

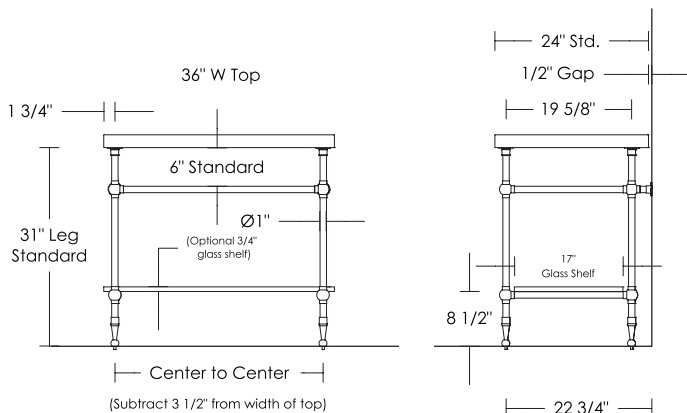

UA2743-B SL 4 Legs [1"Ø] with 2 Lower Bars
with Mott Cap & Foot

Industrial Base [1"Ø Metal]

Industrial Base 2 Legs [1"Ø] with 2 Lower Bars

UA2741-B SL

- \$4,700 Price 1
- \$5,900 Price 2
- \$6,100 Price 3
- \$6,700 Price 4

Industrial Base 3 Legs [1"Ø]

UA2742 SL

- \$4,900 Price 1
- \$6,400 Price 2
- \$6,600 Price 3
- \$6,800 Price 4

Industrial Base 3 Legs [1"Ø] with 2 Lower Bars

UA2742-B SL

- \$5,900 Price 1
- \$7,400 Price 2
- \$7,600 Price 3
- \$7,800 Price 4

Industrial Base 4 Legs [1"Ø]

UA2743 SL

- \$5,600 Price 1
- \$7,100 Price 2
- \$7,400 Price 3
- \$7,600 Price 4

Industrial Base 4 Legs [1"Ø] with 2 Lower Bars

UA2743-B SL

- \$7,600 Price 1
- \$9,100 Price 2
- \$9,300 Price 3
- \$9,900 Price 4

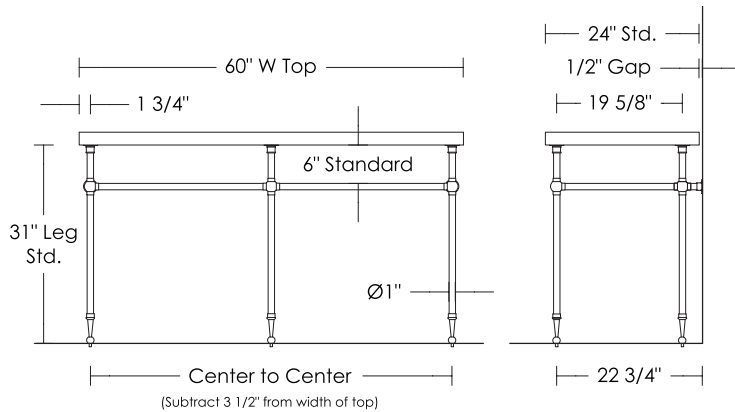

UA2744 SL 5 Legs [1"Ø]
with Mott Cap & Foot

Industrial Base [1"Ø Metal]

Industrial Base 5 Legs [1"Ø]

UA2744 SL

- \$6,800 Price 1
- \$8,300 Price 2
- \$8,500 Price 3
- \$9,800 Price 4

Industrial Base 5 Legs [1"Ø] with 2 Lower Bars

UA2744-B SL

- \$8,800 Price 1
- \$9,300 Price 2
- \$9,500 Price 3
- \$11,500 Price 4

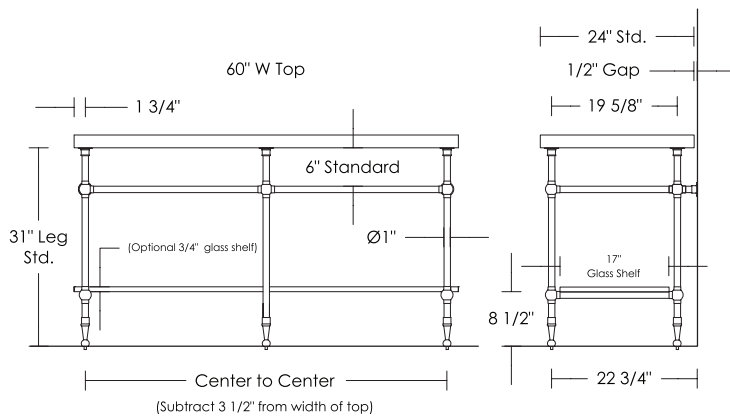

UA2744-B SL 5 Legs [1"Ø] with 2 Lower Bars
with Mott Cap & Foot

Optional glass shelf

- \$425 18" x 30" x 3/4" UA3073-30-WT
- \$490 18" x 36" x 3/4" UA3073-36-WT
- \$535 18" x 42" x 3/4" UA3073-42-WT
- \$595 18" x 48" x 3/4" UA3073-48-WT
- \$725 18" x 60" x 3/4" UA3073-60-WT

Shelves over 48" need additional support

Call for pricing for stone shelf

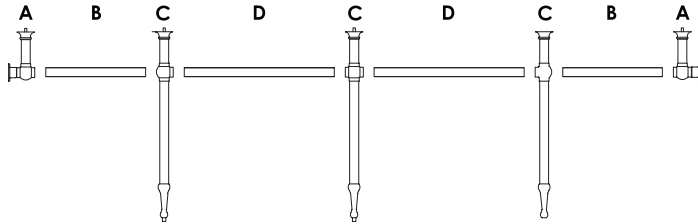
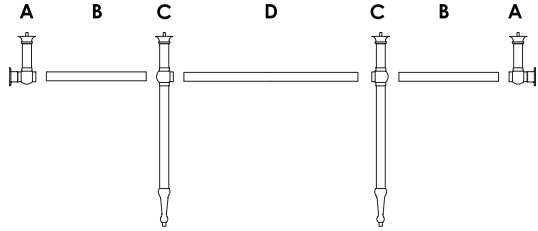

Industrial Base

Installation Notes

To prevent breakage of the glass bars during transit, the following parts will be assembled at the site of the installation. See the diagram at left to identify parts.

- A- Back supports (2)
- B- Glass bars (2)
- C- Legs (2)
- D- Glass bar center (1)

Parts A, B & C to be joined with epoxy (left and right set)

Part C left, D & C right to be joined with set screws (standard for all bases)

Set up and installation instructions, epoxy and set screws are sent with legs and back supports.